

SPECIFICATION

- Bolted Bonnet, Non-Rising Stem, Resilient Wedge, Grooved-End
- 20.7 bar/ 300 PSI Non Shock Cold Working Pressure.
- Conform to AWWA C509, FBE Coated Interior and Exterior
- FM Approved & UL/ULC Listed, Supply by: FlowCom

PRESSURE/TEMPERATURE RATINGS

Working pressure	300PSI/ 20.7 bar
Testing Pressure	Shell: 450 PSI, Seat: 330 PSI
Working temperature	EPDM ≤85°C
Suitable Media	

MATERIALS Specifications

Part	ASTM Spec.
1 Body	Ductile Iron ASTM A536
2 Resilient Wedge	Ductile Iron ASTM A536 + EPDM Encapsulation
3 Wedge Nut	Bronze ASTM B584 UNS C83600
4 Stem	Stainless Steel ASTM A 276 UNS S41000
5 Bonnet Gasket	EPDM
6 Bonnet Screw	Alloy Steel ASTM A 574M Znc Plated
7 Bonnet	Cast Iron ASTM A 126-B
8 Stem Primary O-Ring	EPDM
9 Stem Thrust Washer	Stainless Steel ASTM A 276 UNS S41000
10 Gland Seal O-Ring	EPDM
11 Stem Ring Wiper	EPDM
12 Operating Nut Washer	Carbon Steel Znc Plated
13 Operating Nut Screw	Alloy Steel ASTM A 574M Znc Plated
14 Square Operating Nut	Cast Iron ASTM A 126-B
14A Handwheel	Ductile Iron ASTM A536
15 Stem Primary O-Ring	EPDM
16 Stem Seal Bushing	Brass ASTM B16 UNS C36000

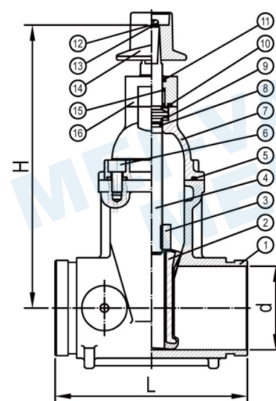

Dimension

Size		L		d		H		Tums to Open
In.	mm	In.	mm	In.	mm	In.	mm	
2.5	65	7.5	190	2.5	64	11.4	289	8.8
3	80	8	203	3	76	12.7	322	10.5
4	100	9	229	4	102	13.5	342	13.75
6	150	10.5	267	6	152	17	432	16
8	200	11.5	292	8	203	20.4	519	17.5
10	250	13	330	10	254	21.2	539	21.5
12	300	14	356	12	305	26.5	672	25.5

Note: Freezing Weather Precaution Subsequent to testing a piping system, valves should be in an open position complete drainage.